

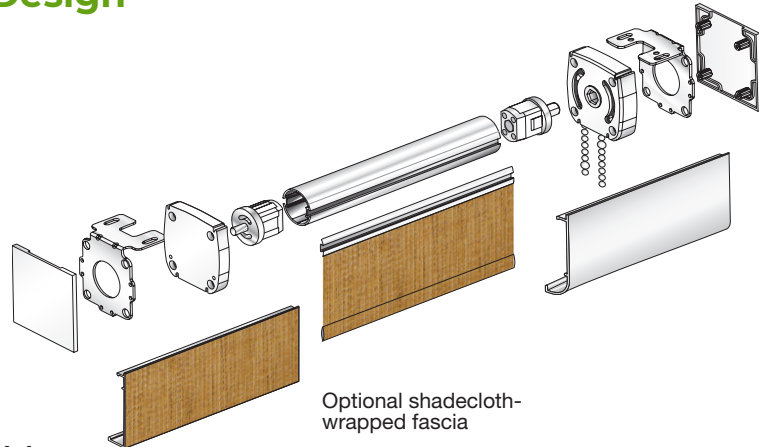

UrbanShade® System

Compact and Versatile Design

The new UrbanShade™ System is a competitively priced, high-design window covering. It's easily reconfigured in the field for special site conditions. The system is suitable for residences, home theaters, small-commercial spaces, and A/V and conference areas. Featuring high-quality and durable components, UrbanShade™ is ideal when aesthetics, flexibility, and competitive pricing are desirable.



Models

- Manual—smooth operation with a continuous bead chain
- Motorized—battery powered with RTS wireless remote control
- Motorized—low voltage with wireless RTS + dry-contact control (available summer 2010)

Economical

- Cost effective—competitively priced

Reliability

- Sturdy—heavy-duty steel support brackets with ultra-durable composite housing
- Powerful—allows for shades up to 10 ft. (305cm) high
- Reliable—ten-year non-depreciating warranty

Design attributes

- Versatile—integrated and interchangeable components
- Flexible—universal mounting brackets provide for easy on-site reconfiguration
- Compact—small edge-clearance to reduce light leaks
- Sleek—refined, unobtrusive profile

Easy installation

- Innovative—universal mounting brackets (wall, ceiling, or jamb)
- Adaptable—interchangeable left and right drive brackets
- Efficient—optional Prefabricated Cassette for fast installation
- Manageable—SnapLoc® Mini spline enables easy shadecloth removal and maintenance

Controls

- Simple—manual hand-operated continuous bead chain
- Interoperative—optional wireless RF/RTS or hard-wired low-voltage control
- Direct—optional dry-contact daisy-chained switch control

Options

- Decorative—SnapLoc® fascia continuous or captured, and baked enamel finish or shadecloth wrapped
- Room darkening—side and sill channels
- Functional—Lift-Assist Mechanism for heavy manual shades





Manual UrbanShade® System

Standard shade prices include:

One pair of universal UrbanShade™ brackets, chain, chain retainer, shadecloth with shadecloth-covered hembar, SnapLoc® spline, and a 1¼ in. or 1⅜ in. SnapLoc® tube.

Universal mounting

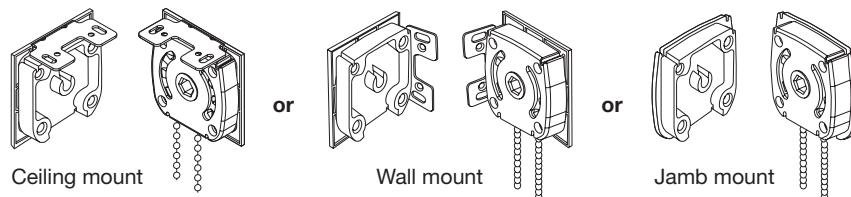

Standard components:

End Plate options:

- 1a Square Fascia Captured End Plate
- 1b Round Fascia Captured End Plate
- 1c Universal Continuous Backplate (square or round fascia)
- 1d No Fascia Backplate
- 1e Universal Jamb-Mount Continuous Plate (square or round fascia)
- 2 Concealed Steel Mounting Plate
- 3 Idle-End Housing
- 4 Screws
- 5 Idle-End Tube Plug or LAM if required (not shown)
- 6 SnapLoc® Tube
- 7 Drive-End Tube Plug
- 8 Drive-End Housing for manual shades
- 9 Upper and Lower Bead Chain Stops for manual shades
- 10 Bead Chain Connector for manual shades
- 11 Chain retainer for manual shades
- 12 SnapLoc® Mini Spline
- 13 Standard fabric wrapped hembar

Optional accessories:

- 14 Exposed Hembar with Light Seal
- 15 Spring-Loaded Tension Pulley Chain Retainer for manual shades
- 16 Room-Darkening Side Channel (single)
- 17 Room-Darkening Shadecloth Guides (pair)
- 18 SnapLoc® Regular-Roll Fascia—square
- 19 SnapLoc® Regular-Roll Fascia—radius
- 20 Wall-mount extension bracket

Contact supplier for all pricing on optional accessories

Manual UrbanShade™ System exploded view

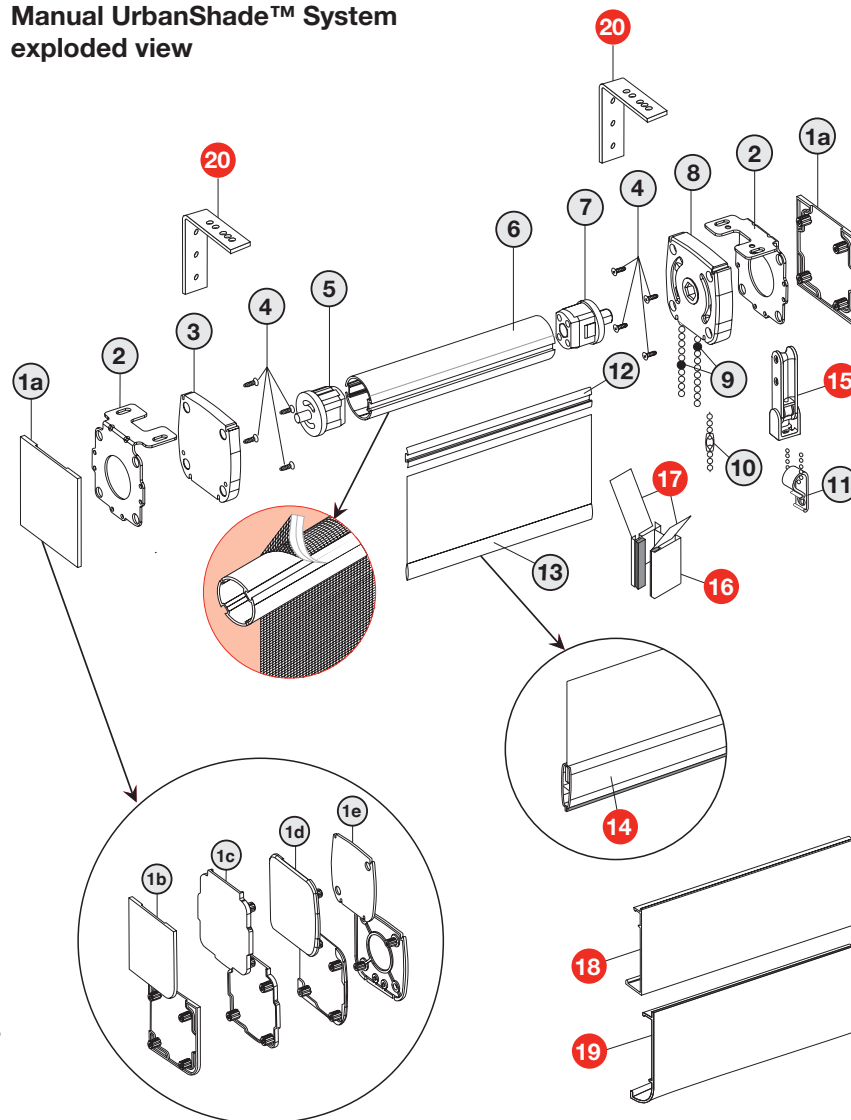



Motorized UrbanShade® System

Standard shade prices include:

One pair of universal UrbanShade™ brackets, shadecloth with shadecloth-covered hembar, 12 Vofit, battery powered motor, battery pack, SnapLoc® spline, and a 1 3/8 in. SnapLoc® tube. Shadecloths that are railroaded are turned width for height.

Universal mounting

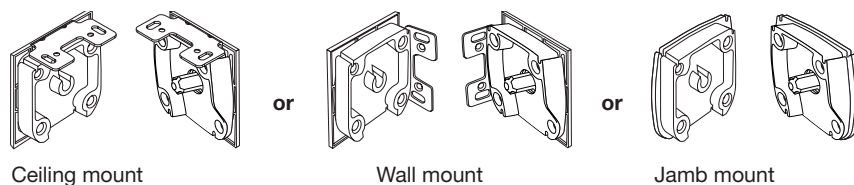

Standard components:

End Plate options:

- ①a Square Fascia Captured End Plate
- ①b Round Fascia Captured End Plate
- ①c Universal Continuous Backplate (square or round fascia)
- ①d No Fascia Backplate
- ①e Universal Jamb-Mount Continuous End Plate (square or round fascia)
- ② Concealed Steel Mounting Plate
- ③ Idle-End Housing
- ④ Screws
- ⑤ Idle-End Tube Plug
- ⑥ SnapLoc® Tube
- ⑦ SnapLoc® Mini Spline
- ⑧ Hembar (standard shadecloth covered)

Standard motorized components:

- ⑨ Motor
- ⑩ Drive End Housing for motorized shades
- ⑪ Motor Spindle
- ⑫ Battery pack

Optional accessories:

- ⑬ Exposed Hembar with Light Seal
- ⑭ SnapLoc® Regular-Roll Fascia—square
- ⑮ SnapLoc® Regular-Roll Fascia—radius
- ⑯ Room-Darkening Side Channel (single)
- ⑰ Room-Darkening shadecloth Guides (pair)
- ⑱ Wall-mount extension bracket
- ⑲ RTS Wireless Remote

Motorized UrbanShade™ System exploded view

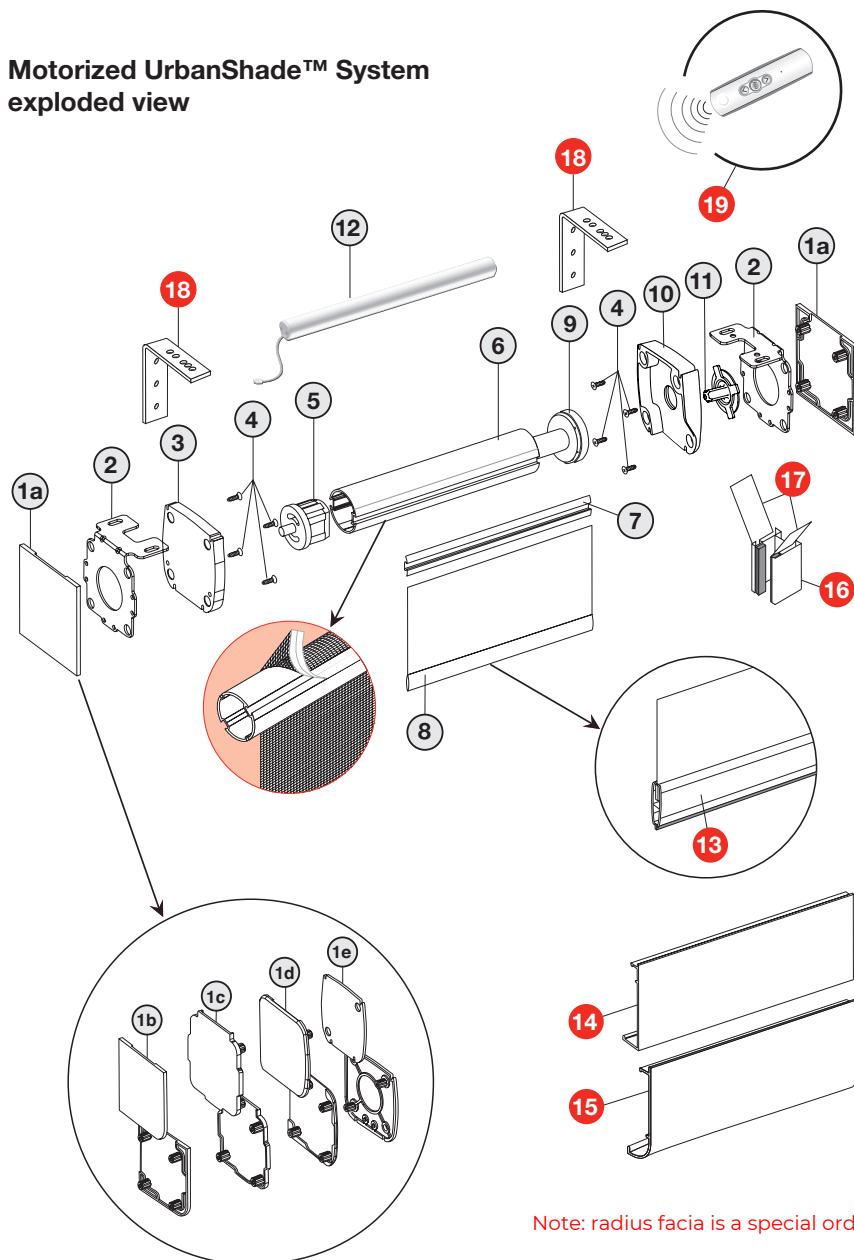



UrbanShade® System Fascia and Specifications

Fascia colors:

- White (WH)
- Alabaster (AL)
- Clear Anodized (CA)
- Quaker Bronze (QB)
- Black (BK)

(Shadecloth-wrapped fascia will match shadecloth color, however shadecloth-wrapped end caps are not available)

Square fascia

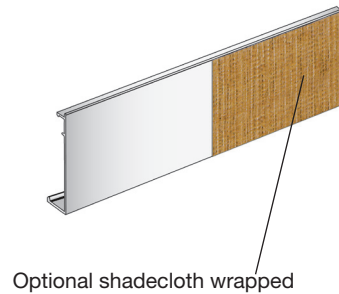

Continuous fascia

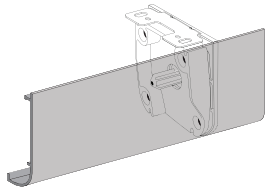

Captured fascia

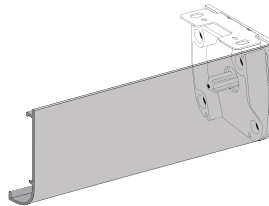

Jamb continuous fascia

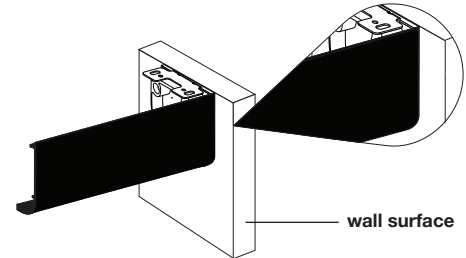

Specifications

| | | |
|-------------------------------|-----------------------------------------------------------------------------------------------------------------------------------------------------------------------------------------------------------------------------------------------------------------------------------------------------------------------------------------------|-----------------------------------------------------------------------------|
| Dimensions: mounting brackets | • 2¾ in. (7cm) deep x 2¾ in. (7cm) high | |
| Mounting | • Wall, ceiling, or jamb mounting; reconfigurable on-site; truly universal | |
| Bracket description | • Heavy duty, zinc plated, steel encased in a high impact, decorative matte-finish composite housing | |
| Roll-up diameter (RUD) | • 2.46 in. (2.5cm) allows shades of up to 10 ft. (305cm) or higher | |
| Edge Clearances | • Drive end 11/16 in. (17mm) • Idle end 5/8 in. (16mm) | |
| Hardware options | • Continuous or captured end caps • Lift-Assist Mechanism (LAM) • Room-Darkening Side and Sill Channels | • Standard Shadecloth-Covered Hembar • Optional Universal Exposed Hembar |
| Bracket color options | • White, Grey, or Black | |
| Fascia profiles | • Square or radius, continuous or captured end plates, baked enamel finish or shadecloth wrapped | |
| Fascia color options | • White (WH), Clear Anodized (CA), Grey (GR), Quaker Bronze (QB), Black (BK), Colonial White (CW), Alabaster (AL) | |
| Lift capacity (manual shade) | • 11 lbs. (5kg) of shadecloth with Lift-Assist Mechanism (LAM) | |
| Maximum width, single band | • 96 in. (244cm) wide | |
| Back-to-back bracket option | • Single bracket provides idle to idle, drive to drive or drive to idle mounting options. Faster installations with fewer brackets to install. Easier alignment of shades for continuous fascia. Reduces shadecloth edge-clearance by an 1/8 in. (3.17mm) per bracket. Contact your local MechoShade Systems' representative for availability | |
| Motorization options | • Battery-powered motor, wireless RTS, lifting capacity is approx. 6 lbs. (2.7kg) • WhisperShade® low voltage, 2Nm tubular motor, wireless RTS, lifting capacity approx. 17 lbs. (7.7kg). Contact your local MechoShade Systems' representative for availability. | |
| Warranty | • Ten-year non-depreciating warranty | |





UrbanShade® Double-Bracket System

Motorized and Manual

The UrbanShade family now includes an economical two-shade-band system. It can accommodate any combination of:

- Two motorized shades.
- Two manual shades.
- One motorized and one manual shade.

The configuration is a shade system which provides a variety of light- and heat-control options. The versatile design allows two shade bands on two individual tubes to be offset-mounted on a single bracket with any combination of motorized or manual lift systems. The design eliminates the need for two separate brackets and reduces labor, installation time, and cost.

The UrbanShade Double-Bracket can darken a room with maximum privacy or allow views to the outside with solar protection by raising only the opaque shadecloth.

Features

- Available in a compact size of 5.22 x 5.22 in. (13.3 x 13.3cm).
- Fascia offered in captured: square and round, and continuous: square and round, in a full range of colors.
- Suitable for home theaters, media and conference rooms, and bedrooms.
- Cost effective.
- Aesthetically pleasing, strong brackets made of metal with plastic sheaths.
- Choice of battery powered with wireless remote control or low voltage with wireless, RS485, or dry-contact controls.

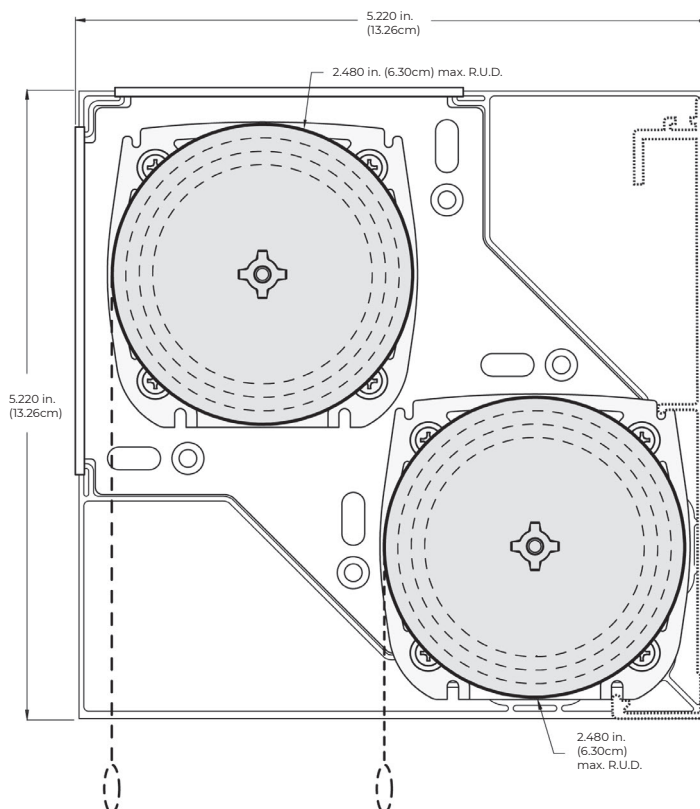

Single-Bracket System

- Manual chain-driven system with an optional LAM (Lift-Assist Mechanism).
- Motorized—battery powered with wireless remote control.
- Motorized—low voltage with wireless, RS485, or dry-contact control.
- Manual-to-motorized conversion kit.

Double-Bracket System

- Manual-to-motorized conversion kit.
- Manual double-bracket with an optional LAM (Lift-Assist Mechanism).
- Motorized double-bracket.



UrbanShade® Double-Bracket System

Motorized and Manual

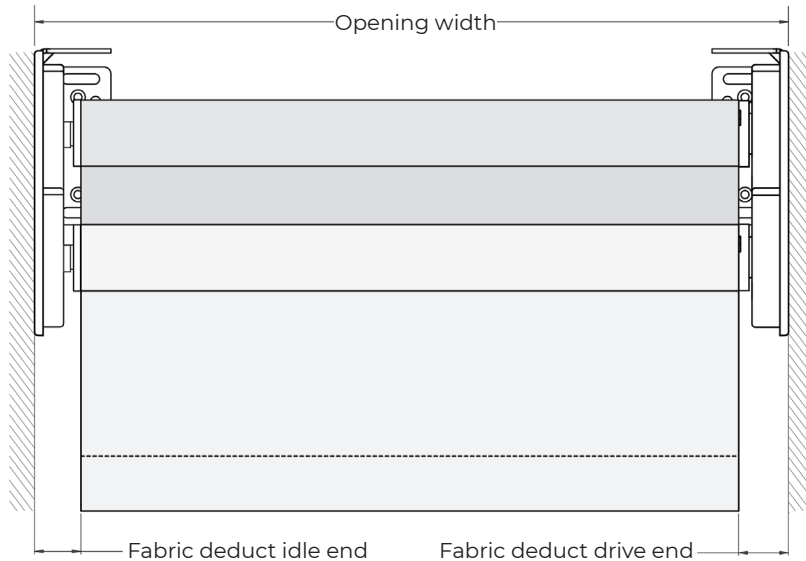

Shade system deductions

| Deduct | Options | Drive | Idle | Total |
|--------------------------------------------|---------------------------------|--------------------|--------------------|--------------------|
| Fabric (motorized) | Concealed Hembar | 0.750 in. (1.91cm) | 0.688 in. (1.75cm) | 1.438 in. (3.65cm) |
| | Exposed 1.5 in. (3.81cm) Hembar | | | |
| | Exposed Universal Hembar | | | |
| | Exposed Hembar with Guide Cable | 1.25 in. (3.18cm) | 1.25 in. (3.18cm) | 2.5 in. (6.35cm) |
| | Exposed Hembar with Guide Wheel | | | |
| Fabric (manual w/ LAM) (manual w/o LAM) | Concealed Hembar | 0.875 in. (2.22cm) | 0.688 in. (1.75cm) | 1.563 in. (3.97cm) |
| | Exposed 1.5 in. (3.81cm) Hembar | | | |
| | Exposed Universal Hembar | | | |
| | Exposed Hembar with Guide Cable | 1.375 in. (3.49cm) | 1.375 in. (3.49cm) | 2.750 in. (6.99cm) |
| | Exposed Hembar with Guide Wheel | | | |

Shade systems and size and weight limitations

| | Tube diameter | Motor | Max. R.U.D. | Max. hanging weight | Max. no. turns | Min. opening width |
|----------------|--------------------|-------|-------------------|----------------------------|----------------|--------------------|
| Motorized | 1.375 in. (3.49cm) | LT-30 | 2.48 in. (6.30cm) | < or = 14.2 lbs. (6.44kg) | 40 | 13 in. (33.02cm) |
| | 1.563 in. (3.97cm) | ST-30 | | < or = 22.6 lbs. (10.25kg) | 35 | 19 in. (48.26cm) |
| Manual w/LAM | 1.230 in. (3.12cm) | - | | < or = 12 lbs. (5.44kg) | 28 | 21 in. (53.34cm) |
| | 1.375 in. (3.49cm) | - | | < or = 12 lbs. (5.44kg) | | |
| | 1.563 in. (3.97cm) | - | | < or = 11 lbs. (4.99kg) | | |
| Manual w/o LAM | 1.230 in. (3.12cm) | - | | < or = 7 lbs. (3.18kg) | No limit | 12 in. (30.48cm) |
| | 1.375 in. (3.49cm) | - | | < or = 6 lbs. (2.72kg) | | |
| | 1.563 in. (3.97cm) | - | | < or = 5.5 lbs. (2.49kg) | | |



UrbanShade[®] - Door Mounted Shade

The UrbanShade[™] System is a competitively priced, high-design window covering.

It's easily reconfigured in the field for special site conditions.

The system is suitable for residences, home theaters, small commercial spaces, and A/V and conference areas.

Featuring high-quality and durable components, UrbanShade[™] is ideal when aesthetics, flexibility, and competitive pricing are desirable.

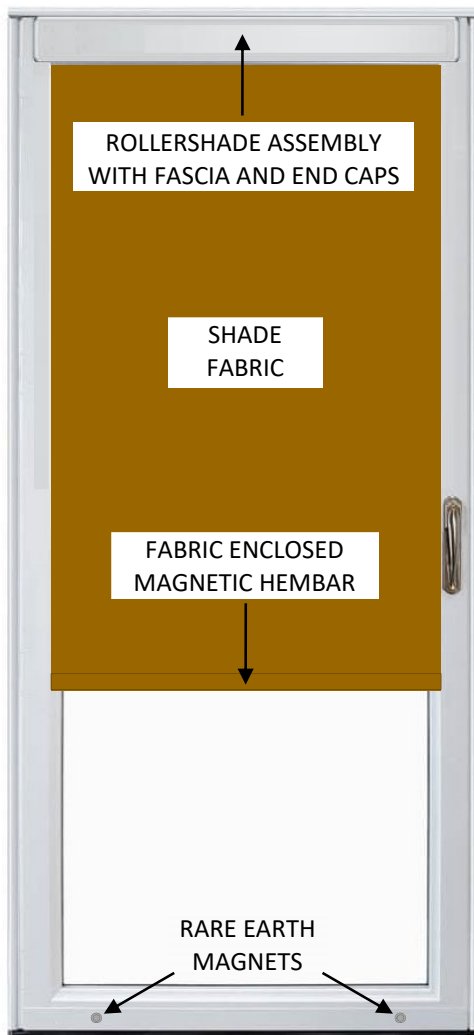
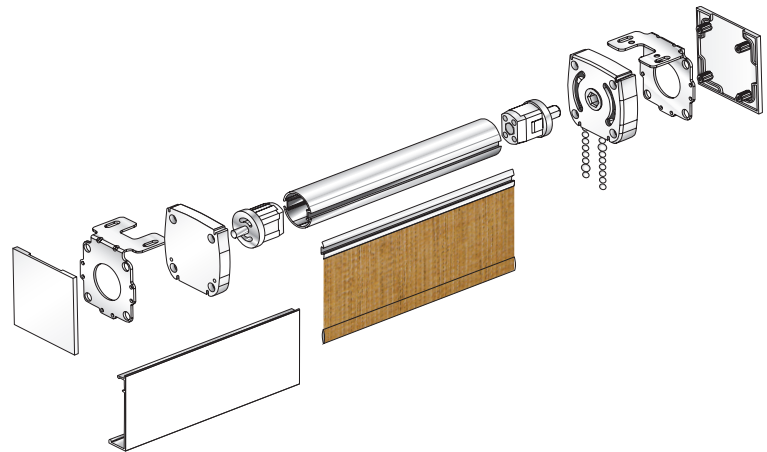

Models

- Manual-smooth operation with a continuous bead chain
- Motorized-battery powered with RTS wireless remote control
- Motorized-low voltage with wireless RTS + dry-contact control

Economical

- Cost effective-competitively priced

Reliability

- Sturdy-heavy-duty steel support brackets with ultra-durable composite housing
- Powerful-allows for shades up to 1 Oft. (305cm) high
- Reliable - ten-year non-depreciating warranty

Design attributes

- Versatile-integrated and interchangeable components
- Flexible- universal mounting brackets provide for easy on-site reconfiguration
- Compact- small edge-clearance to reduce light leaks
- Sleek-refined, unobtrusive profile

Easy installation

- Innovative-universal mounting brackets (wall, ceiling, or jamb)
- Adaptable-interchangeable left and right drive brackets
- Efficient- optional Prefabricated Cassette for fast installation
- Manageable-Snaploc[®] Mini spline enables easy shade cloth removal and maintenance

Controls

- Simple-manual hand-operated continuous bead chain
- Interoperative-optional wireless RF/RTS or hard-wired low-voltage control
- Direct-optional dry-contact daisy-chained switch control

Options

- Decorative-Snaploc[®] fascia as square or radius, continuous or captured, and baked enamel finish or shade cloth wrapped
- Room darkening-side and sill channels
- Functional-Lift-Assist Mechanism for heavy manual shades



Manual UrbanShade® System

Regular Roll without Fascia, Wall Mount on Door

