

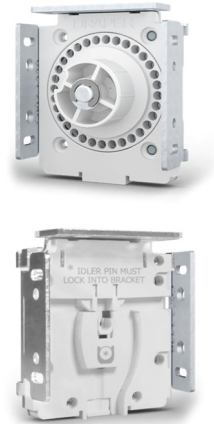

# MANUAL Clutch-Operated FlexShade® NEXD



■ Easy to use and operate, the Clutch-Operated FlexShade® NEXD window shade offers a stylish way to change the look of indoor spaces without the use of automation. NEXD provides light control with a bead chain clutch. A height-adjustable idler bracket is included for fine leveling adjustment after installation. Various surface or recessed mounting options are available for your indoor application. Choose from solar, decorative, or privacy fabrics. With its hassle-free, maintenance-free clutch, and fine leveling adjustments, the Clutch-Operated FlexShade NEXD offers a long-lasting solution for residential, commercial, healthcare, institutional, and educational settings.

## FEATURES

- Comes with mounting endcaps (standard). Optional fascia with endcaps, surface mounted headbox, or pocket mounted headbox available. Type D Pocket available as an accessory.
- Clutch available in white (standard) or black. Clutch has a single groove for easy alignment of the roller with the idler endcap.
- Steel mounting endcap with integrated NEXD Clutch.
- Height-adjustable idler endcap for fine leveling adjustments after installation.
- Pre-drilled jamb mounting holes.
- Clutch-operated products can be ANSI/WCMA A100.1 compliant for areas where small children are present.
- Product designed for interior use.

## OPTIONS

- Optional dual rollers available upon request.
- Hardware finish choices: clear anodized (standard), black, white, ivory, or charcoal bronze. Custom powder coat colors available.
- Stainless steel bead chain (standard). Polyester chain available in white, black, brown, grey, or ivory at no extra charge. Bead chain clutch operator mounted right- (standard) or left-hand operation.
- Adhesive attachment available upon request in place of spline attachment (standard).

## SIZES

- Maximum width for product exceeds 144" (366 cm), depending on fabric selection.
- Available in 3 hardware sizes: slim, small, and large. Where slim and small are available in the same size, small will be the default choice. The slim version offers a fully assembled cassette-style system with a 3 3/8" (86 mm) profile.



# Clutch-Operated FlexShade® NEXD, Small and Large Hardware

## Specifications

### EQUIPMENT

**NEXD CLUTCH OPERATOR:** Delrin® POM thermoplastic with swaged .354" (9 mm) primary steel post with rotational bearing to ensure smooth and quiet operation. Overrunning design. Positive mechanical engagement of drive mechanism to tube. White (standard) or black color options. Stainless steel bead chain (standard). Ivory, grey, black, white, and brown polyester chain available.

**OPTIONAL SPRING-ASSIST IDLER:** Adjustment-free system includes spring-assist components to reduce lifting forces required to raise the shade. Manufacturer shall provide estimated torque for shade unit. Spring-assist is recommended on estimated non-spring-assist torque above 6 lb-in; required on shades with an estimated torque higher than 15 lb-in.

**ROLLERS:** Extruded aluminum 1 1/8", 2.36", or 3.12" (40, 60, or 79mm) diameter roller tube as appropriate for shade.

### COMPONENTS

**ENDCAPS:** 1018 steel stamping. Two sizes available: SMALL: 3 3/8" x 3 3/8" (96 x 86 mm), LARGE: 4 1/8" x 4 3/8" (117 x 117 mm). Installs to face, ceiling, or jamb. Field convertible between wall left, wall right, or ceiling mount. Idler endcaps to have leveling adjustment.

**ENDCAP COVERS:** Plastic covers push into endcaps for positive engagement. Available in ivory, bronze, black, silver, or white to match fascia.

**HEM BAR:** CLOSED POCKET ELLIPTICAL SLAT: 1" (25mm) aluminum elliptical slat inside of a 1 1/8" (41mm) pocket with heat sealed ends. OPEN POCKET ELLIPTICAL SLAT: 1" (25mm) aluminum elliptical slat with plastic ends inside of a 1 1/8" (41mm) pocket. FLAT EXPOSED HEM BAR: SMALL: 7/8" x 3/8" (22mm x 8mm) and LARGE: 1 1/2" x 3/8" (38mm x 8mm) aluminum rectangular hem bar with plastic endcaps. Powder coated in black, bronze, ivory, white, or clear anodized.

**FABRIC ATTACHMENT:** Spline fabric attachment (standard) allows removal of fabric panel without removal of roller assembly. LSE adhesive fabric attachment available upon request.

**FASCIA:** L-shaped cover of 6063-T5 extruded aluminum. Fascia snaps into place using no exposed fasteners. Clear anodized finish (standard) or available in ivory, bronze, black, or white powder coat.

**SURFACE HEADBOX:** Consists of fascia, "L" shaped back/top cover. Endcaps slide into extrusion without exposed fasteners.

**POCKET HEADBOX:** For pocket installation, includes a "U" shaped back/top/front cover with removable bottom closure panel.

Small Size: 3 3/8" x 3 3/8" (87 x 100 mm)

Large Size: 4 1/8" x 4 3/8" (119 x 119 mm). Some exposed fasteners required.

**TYPE "D" POCKET:** Type "D" Shade Pocket, extruded aluminum, for perimeter installation. Accepts FlexShade® installed with endcaps. Finished in white paint. 5" x 5 3/8" x .125" (127 x 137 x 3 mm) with 7/8" (22 mm) tile support lip & removable bottom closure.

**LIGHT GAP REDUCTION HARDWARE:** Extruded aluminum. Accepts edges of fabric, prevents light gaps. Interior of channel provides for use of flat head screws. Available with or without lining.

"L" ANGLE: 3/4" x 1" x 12'3" (1.9x2.5x373cm); 1" x 2 3/4" x 16' (2.5x7x488cm) or cut to length.

"U" CHANNEL: 1" x 2 1/2" x 16' (2.5x6.4x488cm) or cut to length.

"H" CHANNEL: 1" x 5" x 16' (2.5x12.7x488cm) or cut to length.

VINYL "L" ANGLE: 1 1/2" x 3/4" x 8' (3.81x1.9x243.84cm) stock length only. Installed using adhesive.

**DOWNLOADABLE 3-PART SPECIFICATIONS:** available at [www.draperinc.com](http://www.draperinc.com).

Please note: Dimensions of rollers, operators, and hardware at manufacturer's discretion.

## Mounting Hardware Selections

Please Note: Endcaps have the only attachment points for mounting a manual FlexShade®. Optional fascia and headbox have a thickness of 1/8" (1.6mm).

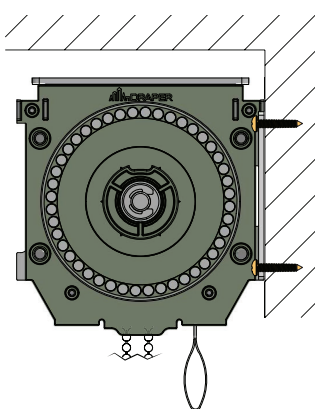

Endcaps Only,  
Wall Mount

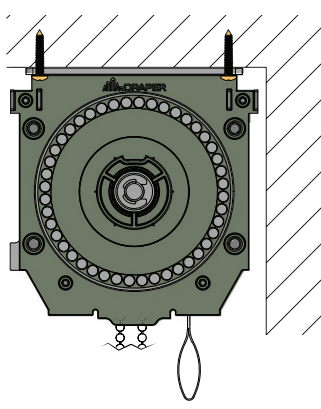

Endcaps Only,  
Ceiling Mount

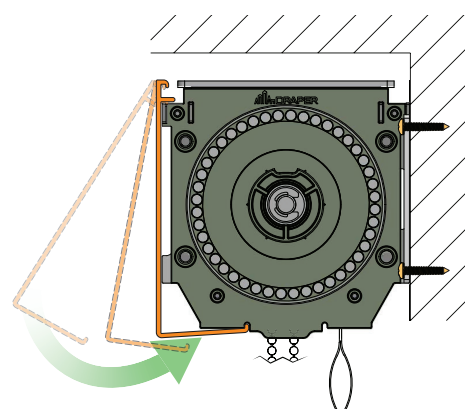

Fascia Only with Ceiling  
or Wall Mounting Endcaps

## Headbox Installation Options

### Surface Headbox

Consists of:

- Fascia
- Back/Top Cover
- Ceiling/Wall Endcaps

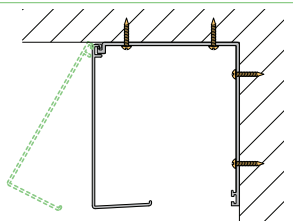

### Pocket Style Headbox

Consists of:

- Extruded Pocket
- Bottom Closure Panel
- Ceiling/Wall Endcaps

SMALL SIZE: 3 3/8" x 3 3/8" (87 mm x 100 mm)

LARGE SIZE: 4 1/8" x 4 3/8" (119 mm x 119 mm)

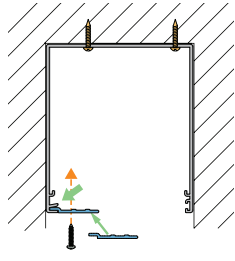

### Type D Pocket

Consists of:

- Extruded aluminum pocket
- A lip supports lay-in ceiling
- Pre-welded corners and ends available
- Ends with or without tile support lip

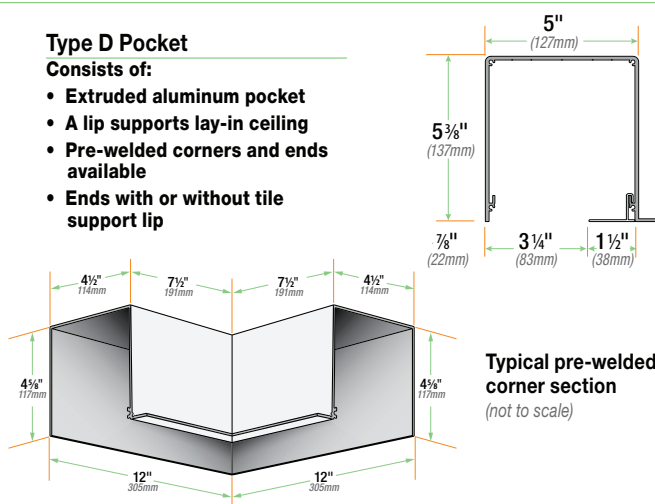

Typical pre-welded  
corner section  
(not to scale)



## Clutch-Operated FlexShade® NEXD, Small and Large Hardware

### Wall Clip and Closure Options

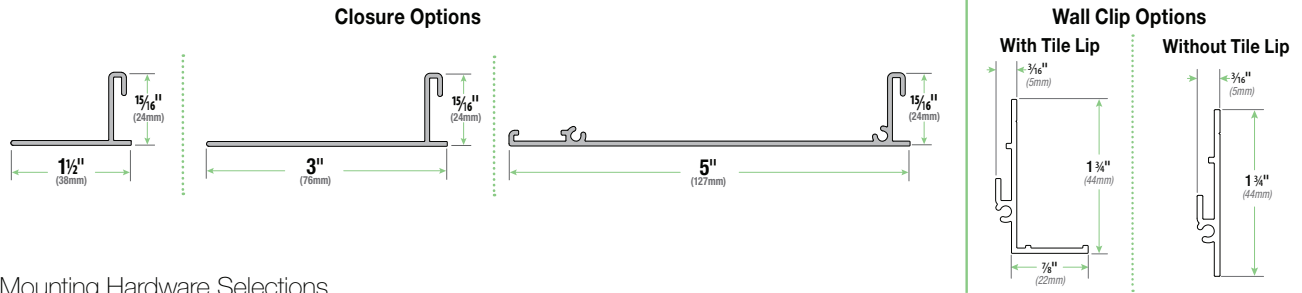

### Mounting Hardware Selections

#### Spline Fabric Attachment

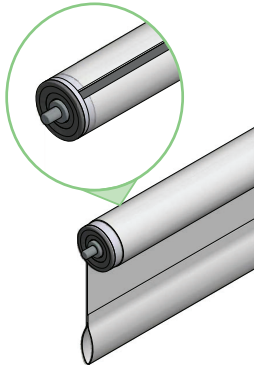

#### "U" Channel

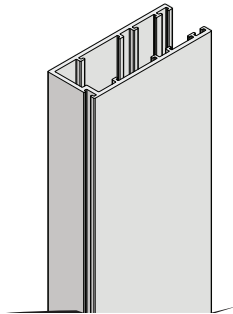

#### "L" Angle

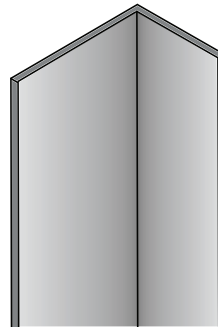

#### "H" Channel

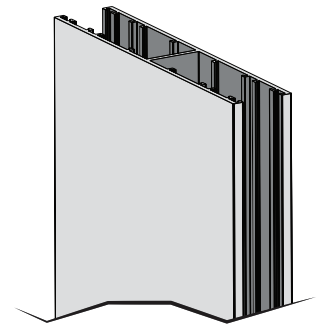

Components (Small Hardware shown)

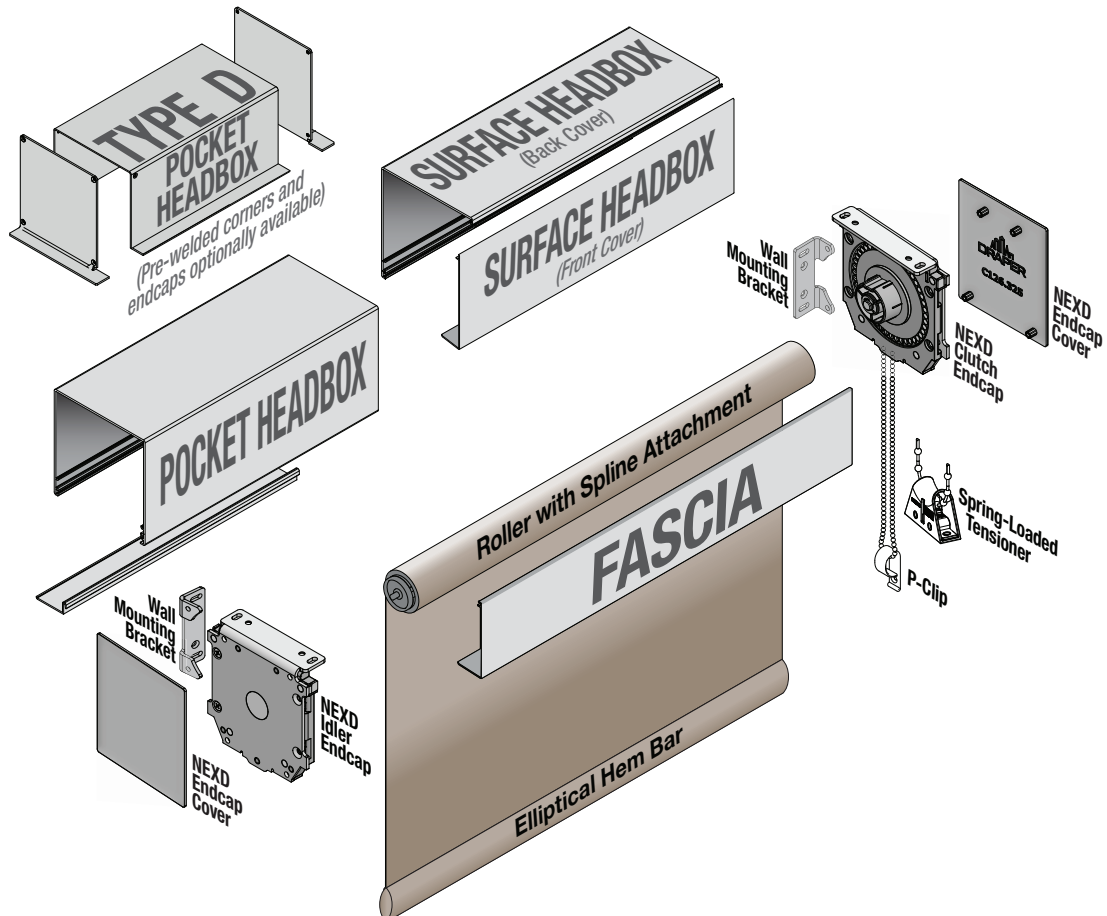



## Clutch-Operated FlexShade® NEXD, Small and Large Hardware

### Dimensions

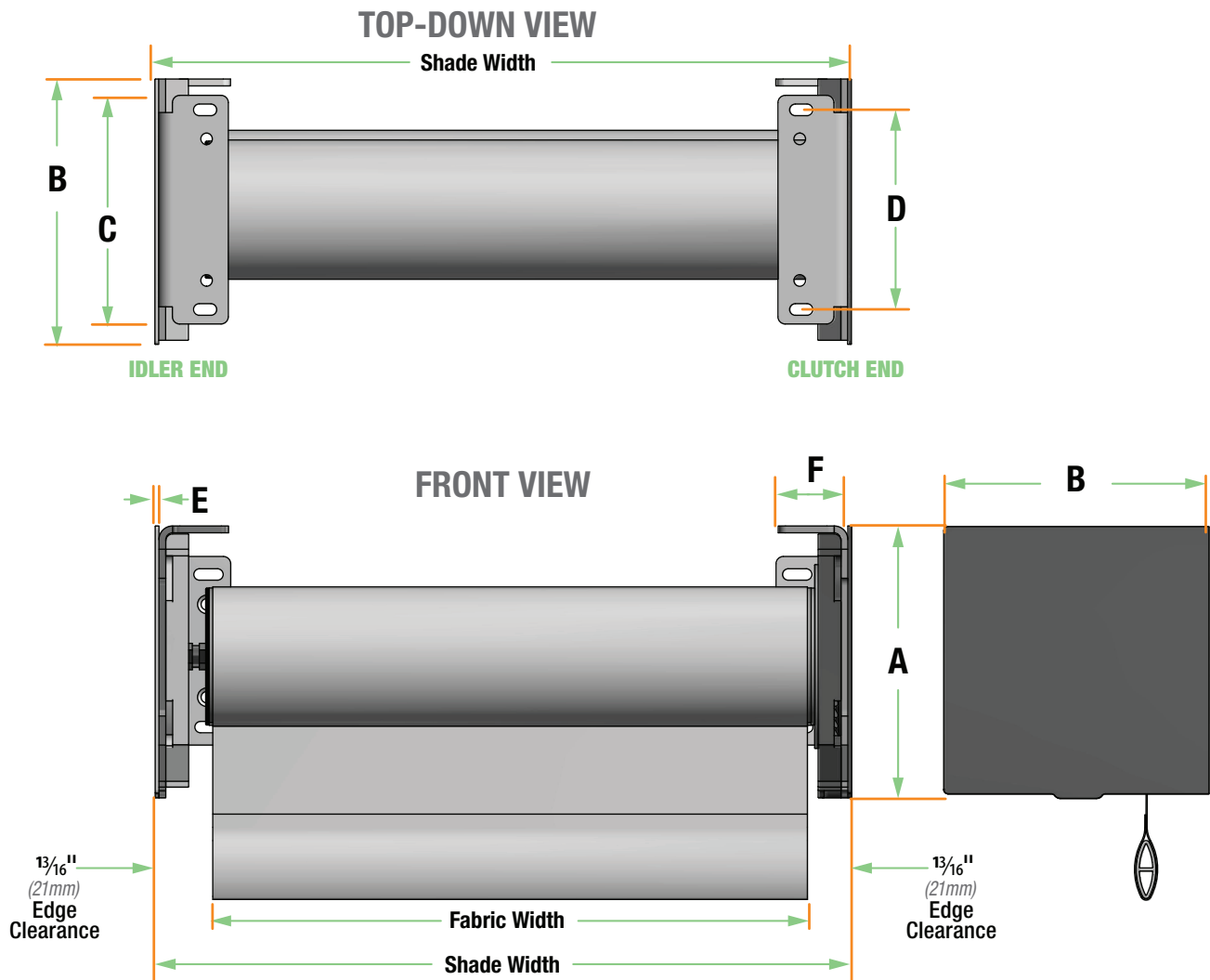

#### FlexShade® NEXD Endcaps & Fascia

	ENDCAPS	
	SMALL	LARGE
A	3 7/8" (98mm)	4 5/8" (117mm)
B	3 3/8" (86mm)	4 5/8" (117mm)
C	2 3/4" (70mm)	3 15/16" (100mm)
D	2 1/8" (54mm)	3 7/16" (87mm)
E	1/16" (2mm)	1/16" (2mm)
F	1 1/4" (32mm)	1 1/4" (32mm)

	ENDCAPS WITH FASCIA	
	SMALL	LARGE
	3 7/8" (98mm)	4 5/8" (117mm)
	3 3/8" (86mm)	4 5/8" (117mm)
	2 3/4" (70mm)	3 15/16" (100mm)
	2 1/8" (54mm)	3 7/16" (87mm)
	1/16" (2mm)	1/16" (2mm)
	1 1/4" (32mm)	1 1/4" (32mm)

	HEADBOX WITH ENDCAPS	
	SMALL	LARGE
	3 15/16" (100mm)	4 11/16" (119mm)
	3 7/16" (87mm)	4 11/16" (119mm)
	2 3/4" (70mm)	3 15/16" (100mm)
	2 1/8" (54mm)	3 7/16" (87mm)
	1/16" (2mm)	1/16" (2mm)
	1 1/4" (32mm)	1 1/4" (32mm)



## Dual Roller FlexShade® NEXD

### Standard Hardware Components

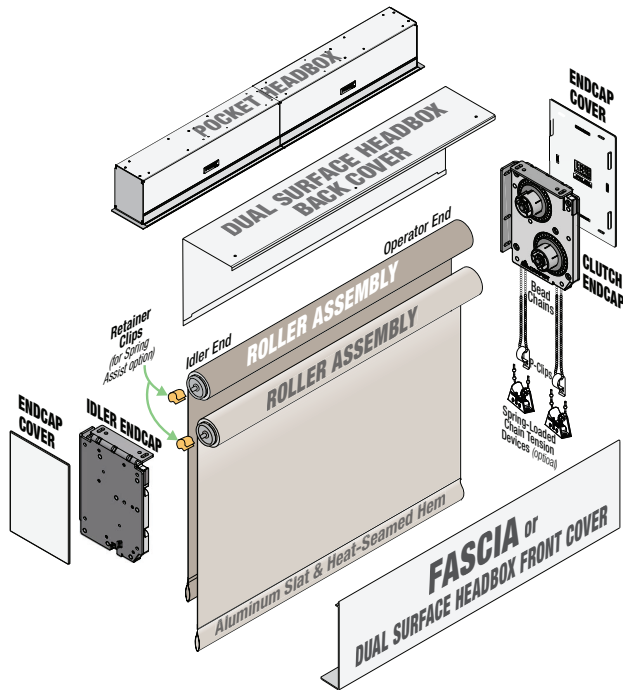

**DUAL ROLLER STANDARD HARDWARE FLEXSHADE NEXD SPECIFICATIONS:**  
Two rollers mounted to a single set of endcaps, to accept fascia.

#### COMPONENTS SPECIFIC TO CLUTCH-OPERATED DUAL ROLLER

**ENDCAPS:** 1028 steel stamping. Complete with adapter roller bracket. Installs to wall or ceiling. Shades mount in vertical configuration (see drawings). Accepts Dual Roller Fascia.

**DUAL FASCIA (FOR ENDCAPS):** L-shaped cover of extruded aluminum, .060" (1.5mm) wall. Assembly snaps onto endcaps without exposed fasteners. Clear Anodized (standard), black, white, ivory, or bronze powder coat finish available.

**DUAL ROLLER POCKET STYLE HEADBOX:** Headbox of 18 GA Steel, painted white on bottom and front, with or without aluminum ceiling tile lip. Removable aluminum bottom closure attaches without exposed fasteners.

Downloadable 3-part specifications are available at [www.draperinc.com](http://www.draperinc.com)

Please note: Dimensions of rollers, operators, and hardware at manufacturer's discretion.

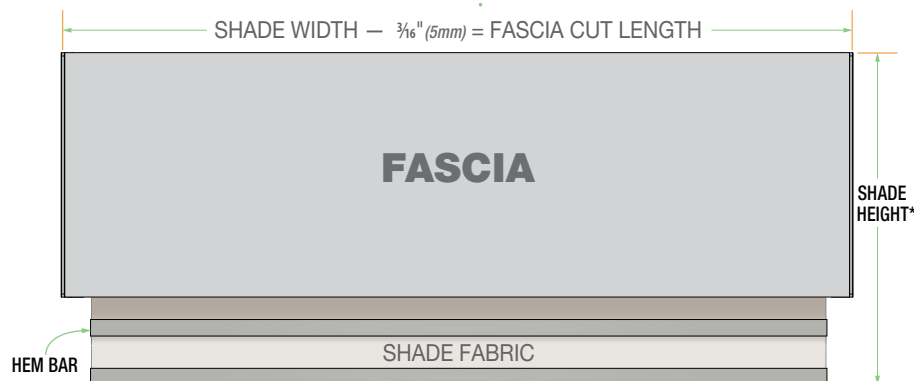
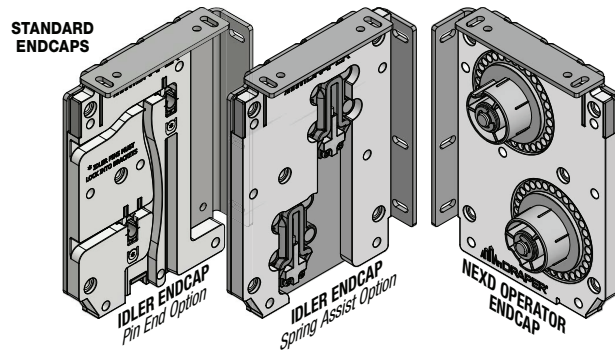

ROLLER TUBE CUT LENGTH -  $\frac{1}{8}"$  (3.2mm) = FABRIC CUT WIDTH  
SHADE WIDTH (Outside Measurement) -  $1\frac{1}{2}"$  (38mm) = ROLLER TUBE CUT LENGTH  
FABRIC CUT WIDTH - 2" (51mm) = HEM BAR CUT LENGTH

\*When measuring shade height, remember to include Endcaps & Fascia.





## Dual Roller FlexShade® NEXD

### Standard Hardware Components

#### Standard Dual Fascia

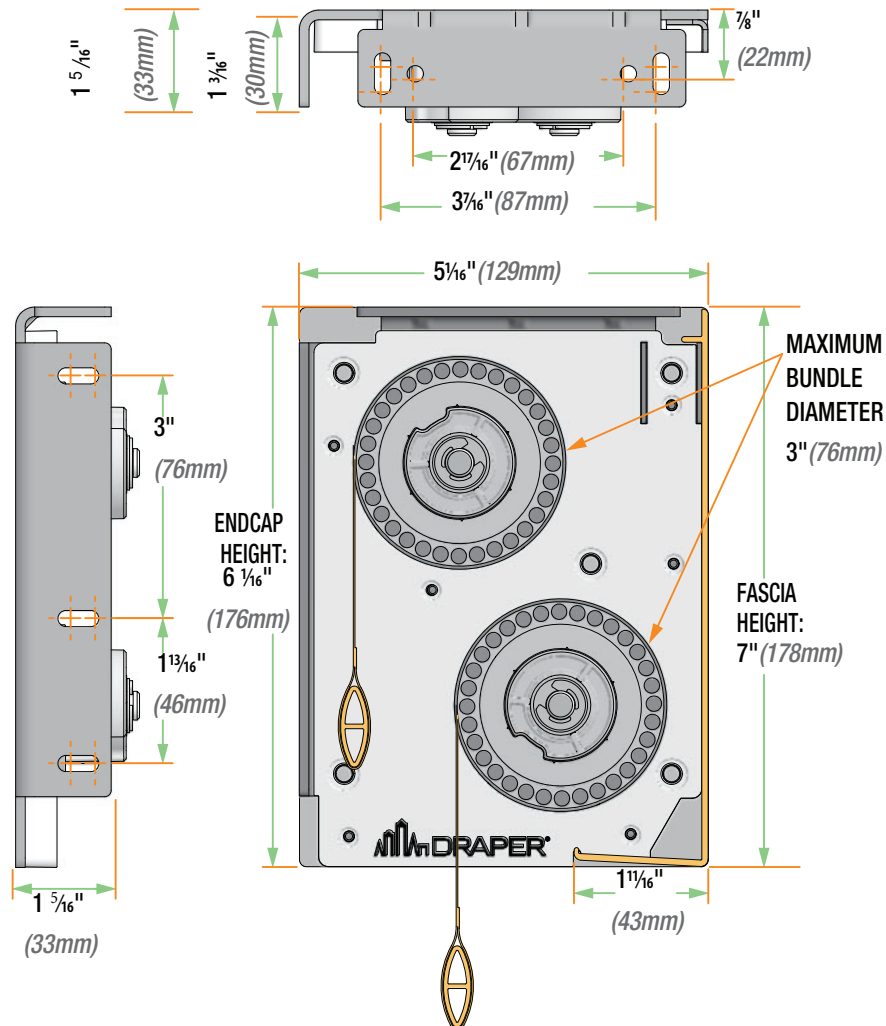



## Dual Roller FlexShade® NEXD

### Standard Hardware Components

#### Standard Dual Surface Headbox

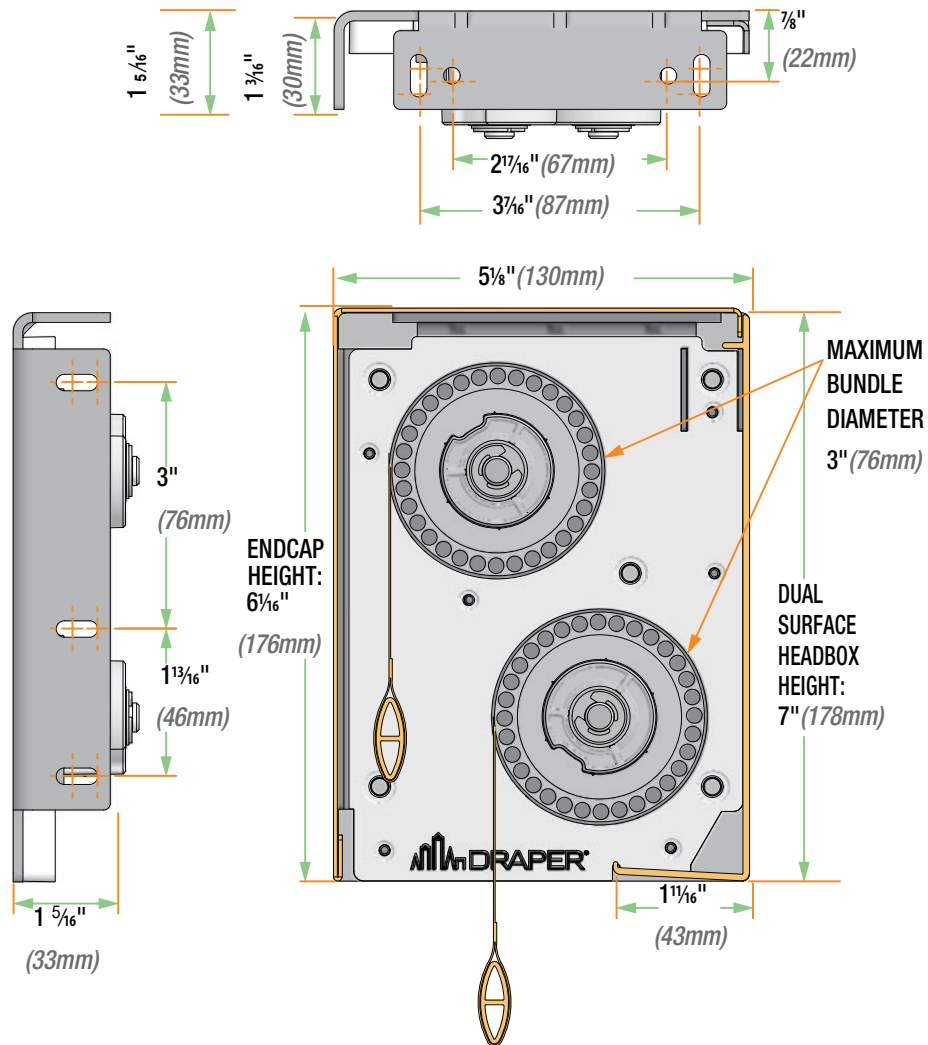



## Dual Roller FlexShade® NEXD

### Extra Large Hardware Components

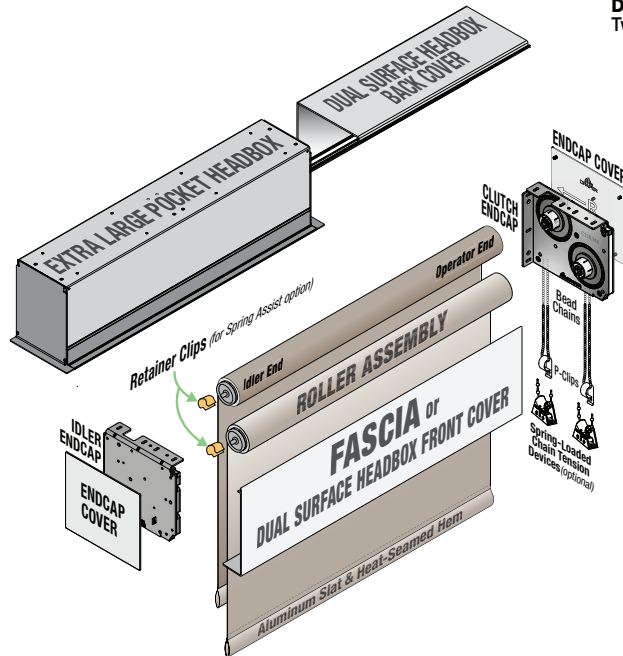

**DUAL ROLLER EXTRA LARGE HARDWARE FLEXSHADE NEXD SPECIFICATIONS:**  
Two rollers mounted to a single set of endcaps, to accept fascia.

#### COMPONENTS SPECIFIC TO CLUTCH-OPERATED DUAL ROLLER

**ENDCAPS:** 1028 steel stamping. Complete with adapter roller bracket. Installs to wall or ceiling. Shades mount in vertical configuration (see drawings). Accepts Dual Roller Fascia.

**DUAL FASCIA (FOR ENDCAPS):** L-shaped cover of extruded aluminum, .060" (1.5mm) wall. Assembly snaps onto endcaps without exposed fasteners. Clear Anodized (standard), black, white, ivory, or bronze powder coat finish available.

**DUAL ROLLER POCKET STYLE HEADBOX:** Headbox of 18 GA Steel, painted white on bottom and front, with or without aluminum ceiling tile lip. Removable aluminum bottom closure attaches without exposed fasteners.

Downloadable 3-part specifications are available at [www.draperinc.com](http://www.draperinc.com)

Please note: Dimensions of rollers, operators, and hardware at manufacturer's discretion.

#### EXTRA LARGE ENDCAPS

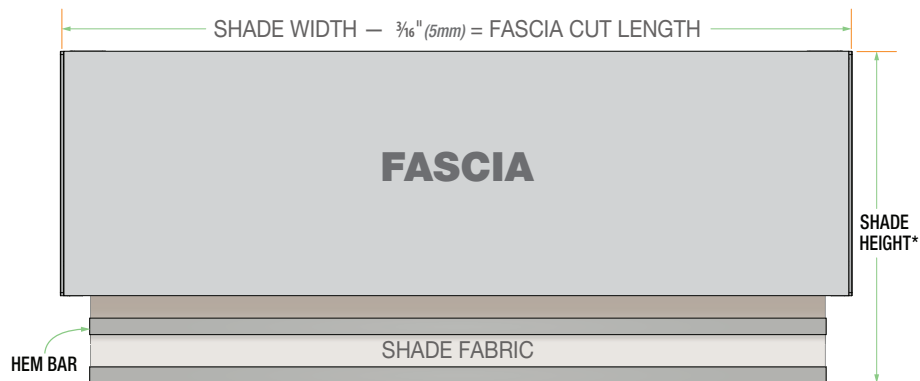
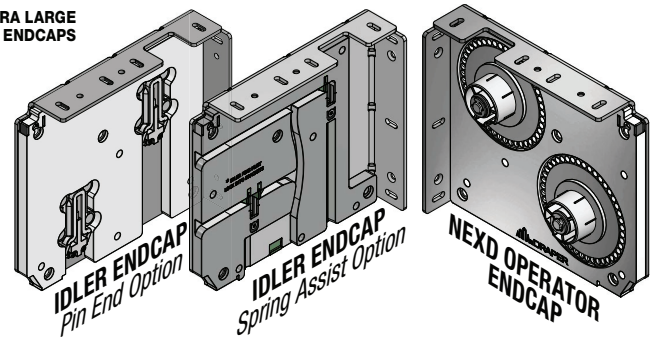

ROLLER TUBE CUT LENGTH -  $\frac{1}{8}$ " (3.2mm) = FABRIC CUT WIDTH  
SHADE WIDTH (Outside Measurement) -  $1\frac{1}{2}$ " (38mm) = ROLLER TUBE CUT LENGTH  
FABRIC CUT WIDTH - 2" (51mm) = HEM BAR CUT LENGTH

\*When measuring shade height, remember to include Endcaps & Fascia.





# Dual Roller FlexShade® NEXD

## Extra Large Hardware Components

## Extra Large Dual Fascia

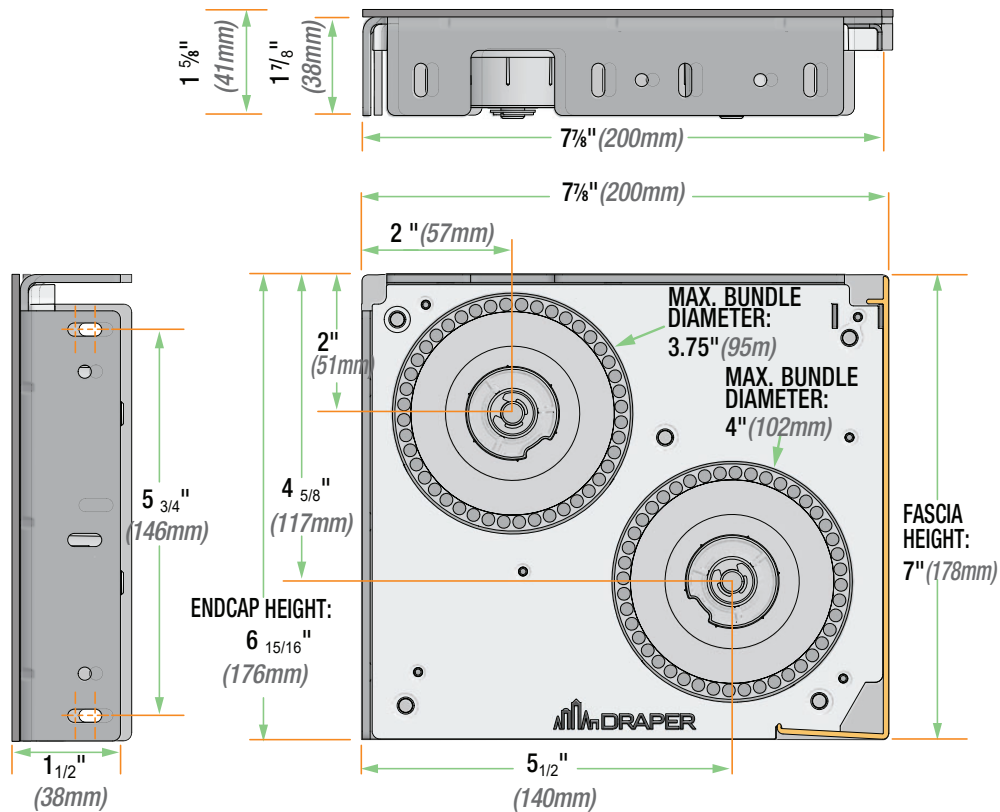



## Dual Roller FlexShade® NEXD

Extra Large Hardware Components

### Extra Large Dual Surface Headbox

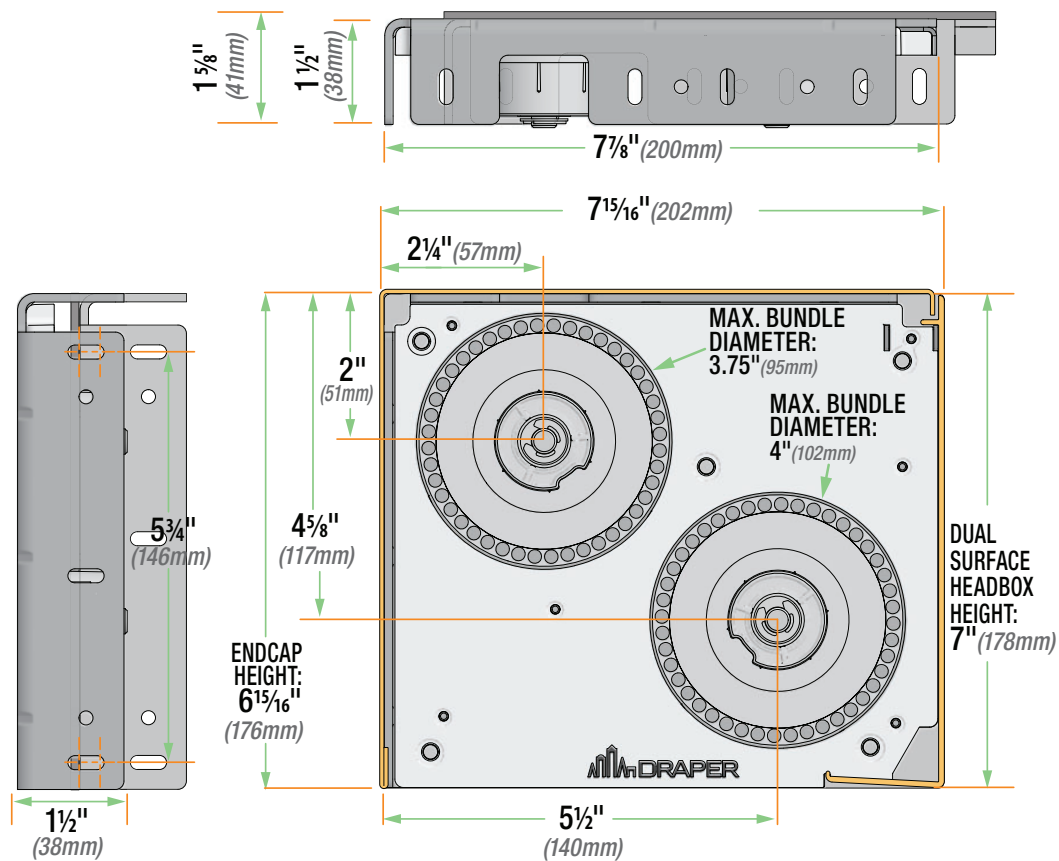



## Dual Roller FlexShade® NEXD

Dimensions: Pocket Headbox

### Standard Hardware Steel Pocket Headbox

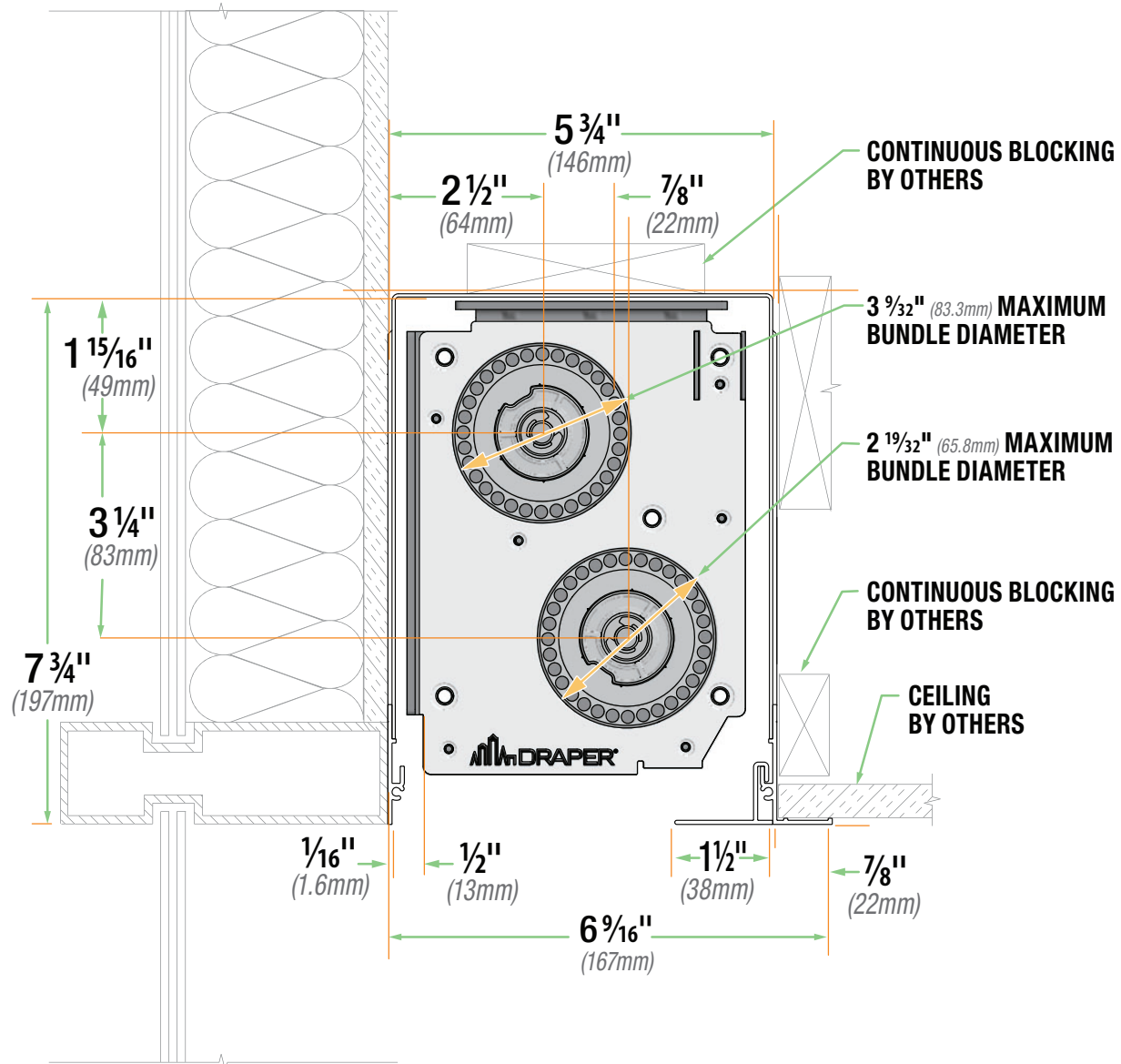



## Dual Roller FlexShade® NEXD

Dimensions: Pocket Headbox

### Standard Hardware Aluminum Pocket Headbox

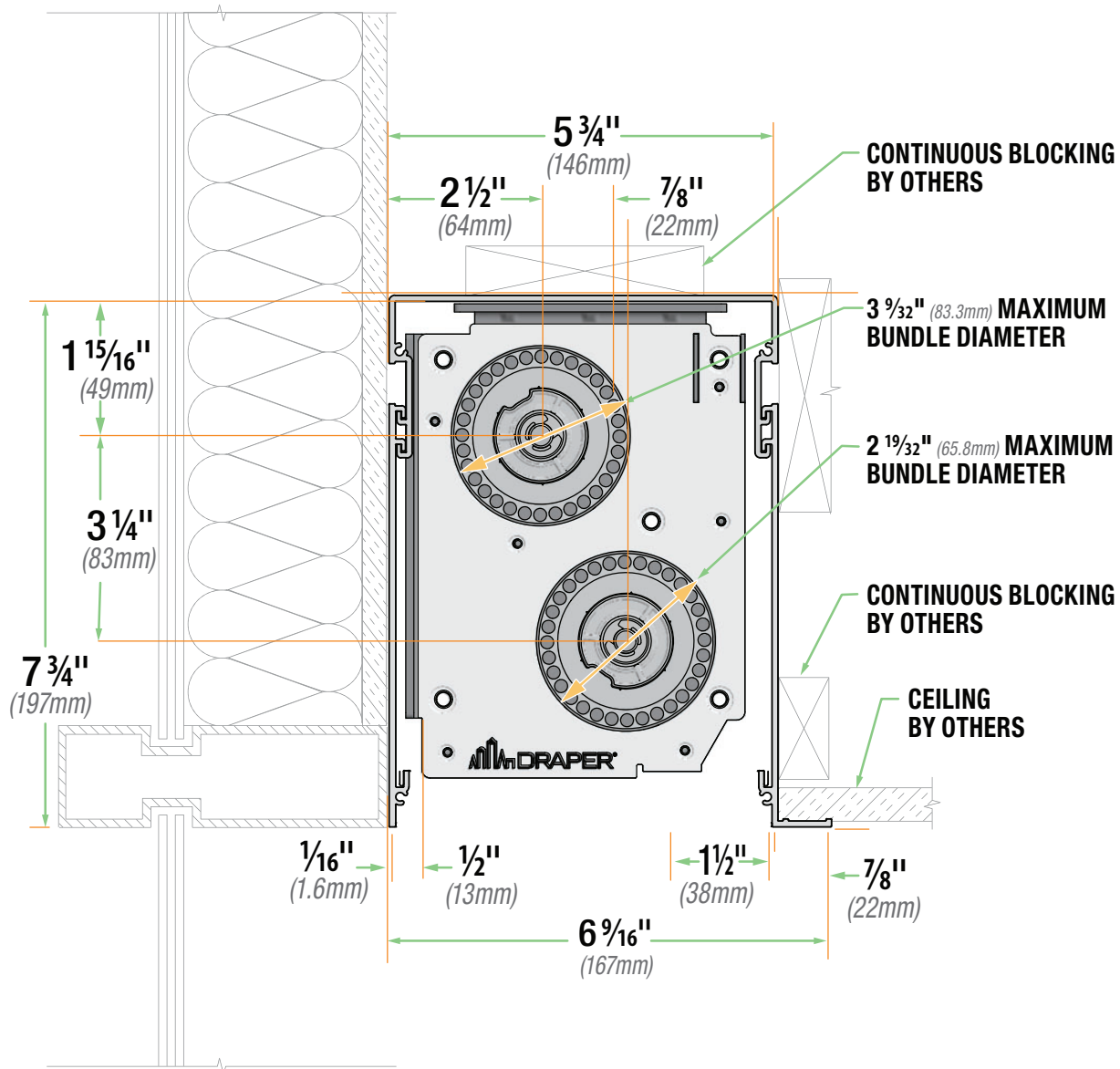



## Dual Roller FlexShade® NEXD

Dimensions: Pocket Headbox

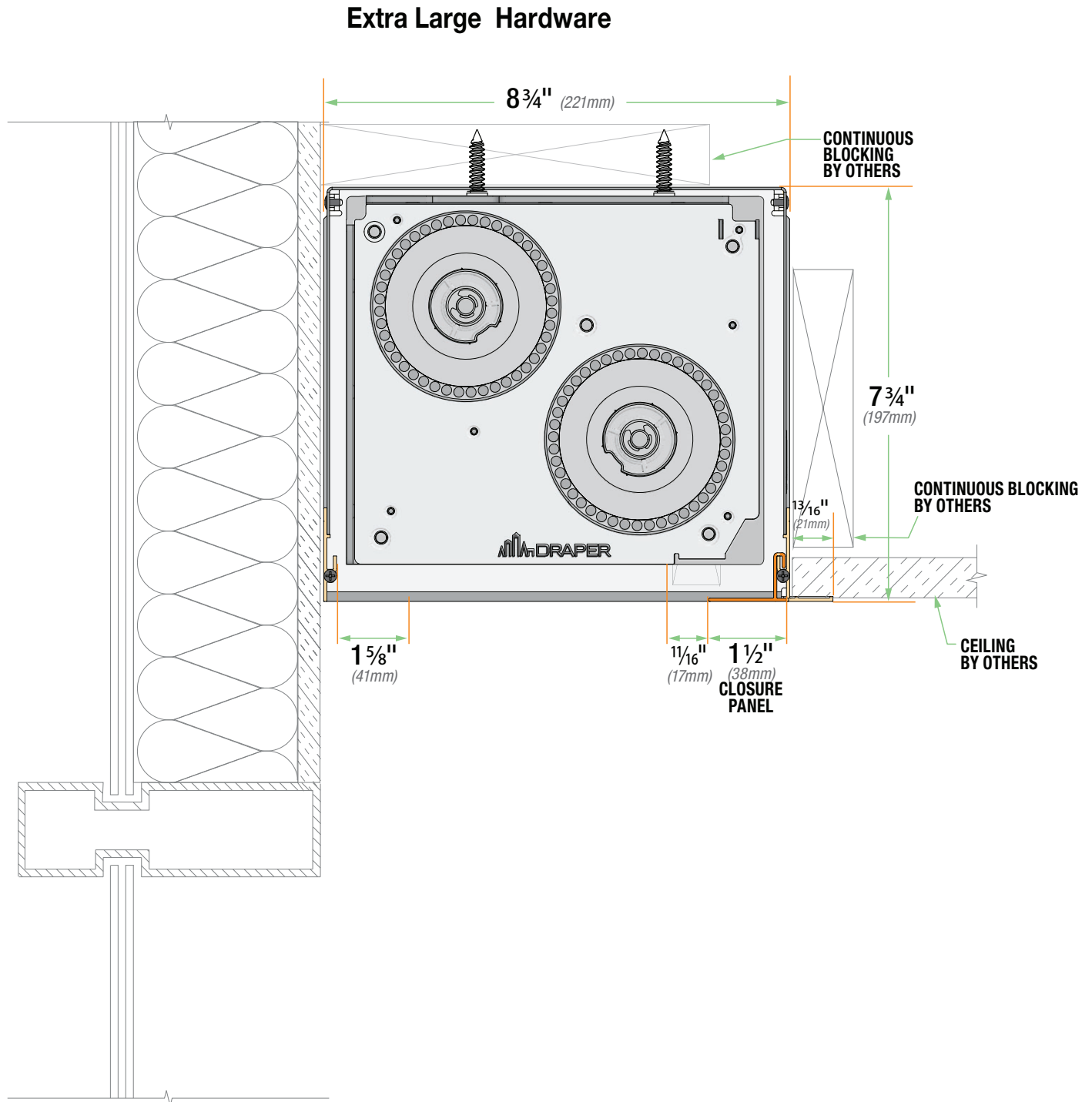



## Bottom-Up FlexShade® NEXD, Small and Large Hardware

Premium manually-operated bottom-up shade

### Components

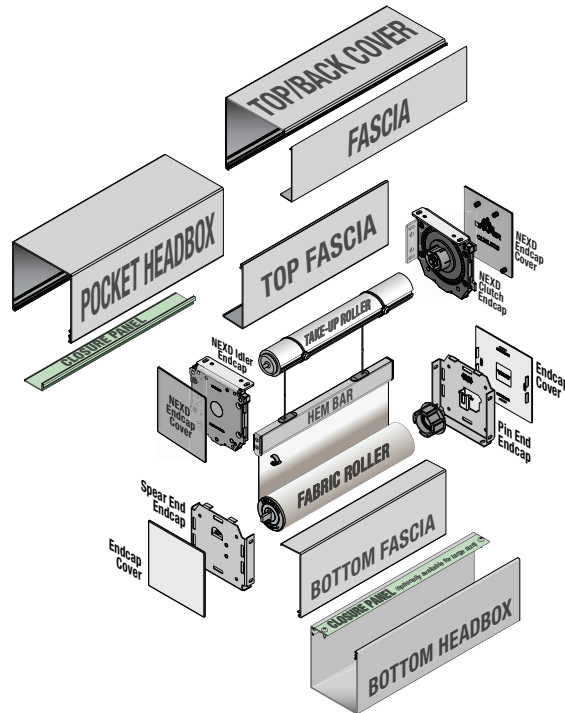

### Available Sizes:

WIDTH:	2'	3'	4'	5'	6'	7'	8'	9'	10'	11'	12'	13'	14'	15'
HEIGHT														
2'														
3'														
4'														
5'														
6'														
7'														
8'														
9'														
10'														
11'														
12'														
13'														
14'														
15'														

\* Sizes requiring large endcaps/brackets will vary according to fabric.

- ☒ Default small
- ☐ Small endcaps/brackets and 1 3/8" (40mm) roller are recommended.
- ☐ Large endcaps/brackets and 3" (76mm) roller may be required.





## Bottom-Up FlexShade® NEXD, Small and Large Hardware

### Specifications

#### EQUIPMENT

**NEXD CLUTCH OPERATOR:** Delrin® POM thermoplastic with swaged .354" (9 mm) primary steel post with rotational bearing to ensure smooth and quiet operation. Overrunning design. Positive mechanical engagement of drive mechanism to tube. White (standard) or black color options. Stainless steel bead chain (standard). Ivory, grey, black, white, and brown polyester chain available.

**ROLLERS:** Extruded aluminum 2", 2.36", or 3.12" (51, 60, or 79mm) diameter roller tube as appropriate for shade.

#### COMPONENTS

**ENDCAPS:** 1018 steel stamping, two sizes available:

SMALL: 3 3/8" x 3 3/8" (86 x 98 mm), LARGE: 4 3/8" x 4 3/8" (117 x 117 mm)

Installs to face, ceiling, or jamb. Field convertible between wall left, wall right, or ceiling mount. Idler endcaps to have leveling adjustment.

**ENDCAP COVERS:** Plastic covers push into endcaps for positive engagement. Available in ivory, bronze, black, silver, or white to match fascia.

**FABRIC ATTACHMENT:** LSE adhesive fabric attachment.

**FABRIC RETAINER:** 1/4" (6 mm) OD .17" (4 mm) ID linear low-density polyethylene tubing, inside heat seamed hem.

**HEM BAR:** Machine extruded aluminum, finished to match fascia. Clear anodized (standard), black, white, ivory, or bronze powder coat finish available. Includes built-in pulley assemblies for lifting cables.

**LIFTING CABLE:** 0.046" (1 mm) OD 7x19 strand low-stretch, high fatigue nylon-coated cable.

**FASCIA:** L-shaped cover of 6063-T5 extruded aluminum. Fascia snaps into place using no exposed fasteners. Clear anodized finish (standard) or available in ivory, bronze, black, or white powder coat.

**SURFACE HEADBOX:** Consists of fascia, "L" shaped back/top cover. Endcaps slide into extrusion without exposed fasteners.

**POCKET HEADBOX:** For pocket installation, includes a "U" shaped back/top/front cover. Removable closure panel available for top installation (Small and Large sizes), and for bottom installation (Large size only).

Small Size: 3 3/8" x 3 3/8" (87mm x 98mm)

Large Size: 4 1/8" x 4 1/8" (119mm x 119mm)

**SOME EXPOSED FASTENERS REQUIRED.**

**PATENT INFORMATION:** Available at [www.draperinc.com/legal/patents](http://www.draperinc.com/legal/patents).

**DOWNLOADABLE 3-PART SPECIFICATIONS:** [www.draperinc.com/documents.aspx](http://www.draperinc.com/documents.aspx).

Entire unit certified by Underwriters' Laboratories, Inc. for the U.S. and Canada.

*Please note:* Dimensions of rollers, operators, and hardware at manufacturer's discretion.

### Dimensions

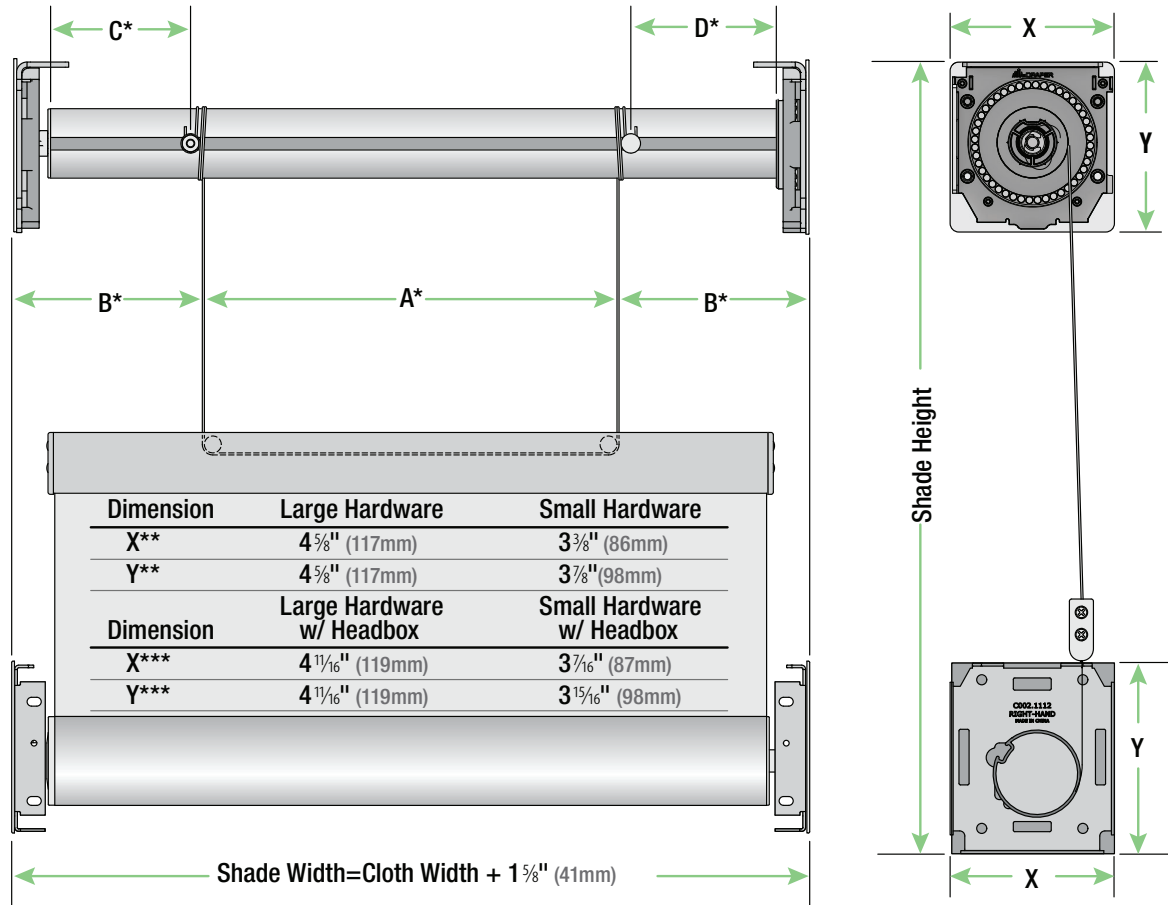

\*These dimensions are different for each shade and are provided by Draper® with your order.

Dimension "A" is a vertical cable spacing.

Dimension "B" is the distance from the vertical cable spacing to the vertical edge of the shade.

Dimension "C" is the distance from the Idler End of the tube to the center of the cable attachment stud.

Dimension "D" is the distance from the Operator End of the tube the center of the cable attachment stud.

\*\*These dimensions apply to Endcap Covers. Endcap or Fascia dimensions fall within this dimension.

\*\*\*Shades with Headbox are 1/8" larger.