



MANUAL Crank-Operated FlexShade®

DETACHABLE OR PERMANENTLY MOUNTED CRANK HANDLE



- With single controller operation, the Crank-Operated FlexShade® provides precision control to easily raise or lower window shade(s) to exact desired height. For added benefit, the crank handle can be permanently mounted or detachable to limit shade access in educational, healthcare, government or institutional settings.

FEATURES

- Crank handle can be permanently mounted (standard) or detachable; up to 6' (183 cm) in length.
- Wall mounting brackets with endcaps included.
- Small or large hardware options available.
- Product designed for interior use.

OPTIONS

- Optional, heavy-duty crank up to 10' (305 cm), or two-piece handle available in greater lengths.
- Hardware finish choices: clear anodized (standard), black, white, ivory, or charcoal bronze. Custom powder coat colors available.

SIZES

- Maximum shade width is 12' (366 cm), depending on fabric selection.



MANUAL Crank-Operated FlexShade®

Components

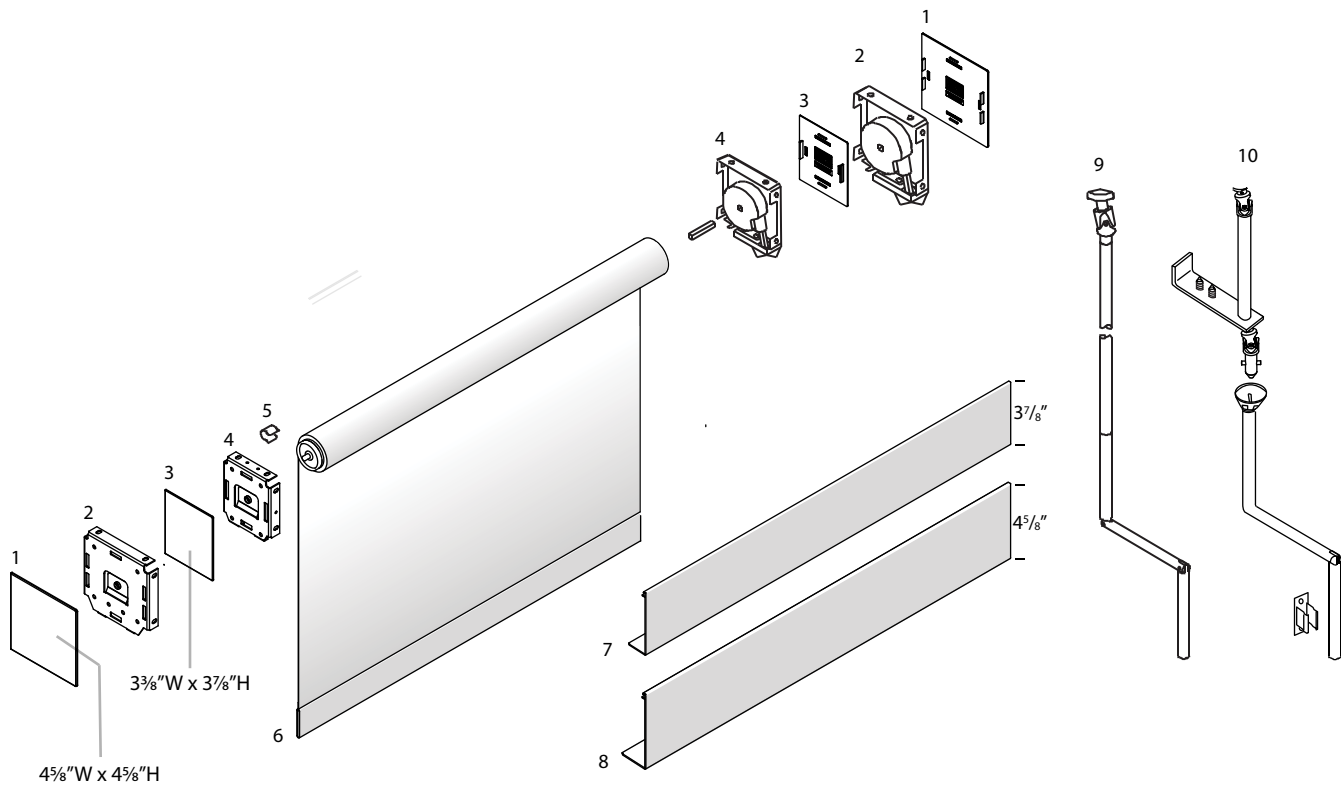

Components

- | | | |
|-------------------------------|---|---|
| 1. Large Plastic Endcap Cover | 6. Hem Pocket with $\frac{13}{16}$ " Dowel | 10. 2-Piece crank handle available for shades 14' or more above floor |
| 2. Large Endcap | 7. Aluminum Fascia Panel (square or radius) | |
| 3. Small Plastic Endcap Cover | 8. Large Aluminum Fascia Panel | |
| 4. Small Endcap | 9. Removeable Crank | |
| 5. Idler End Retainer Clip | | |



MANUAL Crank-Operated FlexShade®

Specifications

Specifications-Crank Operated FlexShades

Equipment

Crank Operator: Gear box, of die cast aluminum and steel, has ratio of 3.0 to 1. Bi-directional to mount at either end of roller. Never needs lubrication or adjustment. Crank handle assembly, of anodized aluminum and chrome plated steel, up to 6' in length, detachable or permanently mounted. Heavy duty crank optionally available in lengths to 10'. Optional 2-Piece crank handle available for shades 14' or more above floor. Crank roller insert, of injection molded nylon and steel, is installed in the roller and engages to gear box.

Components

Rollers (except spring rollers): Sizes 1 1/4" dia. x .030 wall, 1 1/2" dia. with .065 wall, or 2" dia. with .080 wall, in steel or extruded aluminum. Roller assembly easily removable.

Roller Idler Assembly: Fiberglass reinforced polyester thermopolymer (PBT), with spring-loaded pin to interlock with mounting bracket.

Slat: 1 3/16" tube, encased in hem.

Coupler Assembly: Zinc plated steel Coupler Shafts shall be retractable into coupler assembly for ease of installation and to lock units in place. Zinc plated steel coupler brackets shall have spherical OD bearings allowing for misalignment of the mounting brackets of up to 1.25-degrees. One crank operator to drive additional shade rollers. Patent Pending.

Endcaps: 1018 steel stamping. 2 sizes: 3 1/4" x 3 3/4" and 4 1/2" x 4 1/2". Complete with adapter roller bracket. Installs to face, ceiling, or jamb. Accepts box covers and fabric guide.

Endcap Covers: Plastic covers snap onto endcaps. Available in ivory, bronze, black or white to match fascia.

Fascia: L-shaped or radius cover of extruded aluminum, .060 wall. Assembly snaps onto endcaps without exposed fasteners. Radius fascia on small hardware only-not available on large fascia or crank-operated shades. **Clear anodized (standard)** finish or black, white, ivory or bronze powder coat finish.

Headbox: Standard consists of fascia, L-shaped back/top cover. Assembly snaps onto endcaps. Optional, for pocket installation, includes a U-shaped back/top/front cover with removable bottom closure panel. Small size: 3 7/16" x 3 15/16". Large size: 4 11/16" x 4 11/16". Some exposed fasteners required. **Clear anodized (standard)** finish or black, white, ivory or bronze powder coat finish.

Type D Pocket: Type D Shade Pocket, to be fabricated of metal for perimeter installation. Accepts FlexShades installed with ceiling brackets. Finished in white paint. 5" x 5 3/8" x .125" with 7/8" tile support lip and removable bottom closure. Dual pocket 9 1/2" x 5 3/8" x .125" with 7/8" tile support lip and removable bottom closure.

Battens: In order to ensure proper flatness and tracking, Draper reserves the right to utilize metal battens, installed in pockets across entire width of shade.

"L" Angle (3/4" x 1" x 12'3", 1" x 2 3/4" x 16' or cut to length): Accepts side edges of fabric, prevents light gaps. Interior of channel provides for use of flat head screws.

Please note: Dimensions of rollers, operators and hardware at manufacturer's discretion.

Downloadable 3-part specifications are available at www.draperinc.com.

Zytel® is a registered trademark of E. I. du Pont de Nemours and Company.

DuPont™ is a trademark of E. I. du Pont de Nemours and Company.

Dimensions

Dimensions—Crank-Operated FlexShade

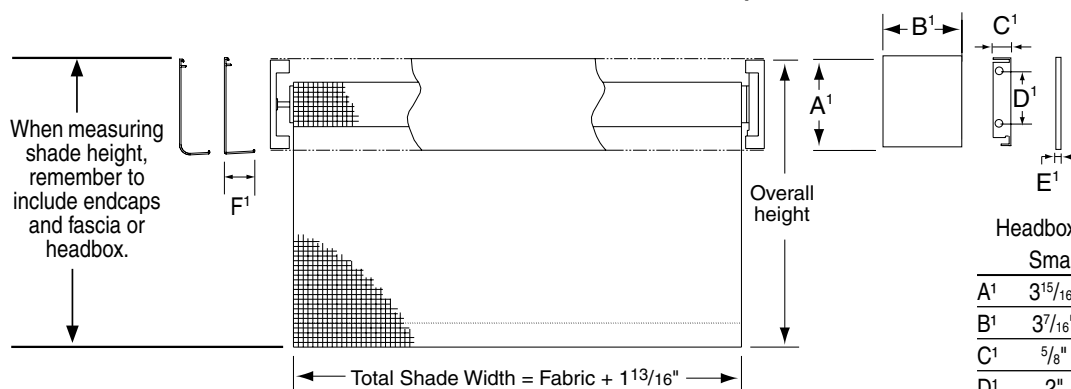

(Fascia Overall Width includes plastic endcap covers)
(Pair adds 1/8" to Overall Width)

Headbox with Endcaps			Endcaps with Fascia		
	Small	Large		Small	Large
A ¹	3 ¹⁵ / ₁₆ "	4 ¹¹ / ₁₆ "	A ¹	3 ⁷ / ₈ "	4 ⁵ / ₈ "
B ¹	3 ⁷ / ₁₆ "	4 ¹¹ / ₁₆ "	B ¹	3 ³ / ₈ "	4 ⁵ / ₈ "
C ¹	5/ ₈ "	5/ ₈ "	C ¹	5/ ₈ "	5/ ₈ "
D ¹	2"	3¼"	D ¹	2"	3¼"
E ¹	1/ ₁₆ "	3/ ₃₂ "	E ¹	1/ ₁₆ "	3/ ₃₂ "
F	1 ³ / ₁₆ "	1 ⁹ / ₁₆ "	F ¹	1 ³ / ₁₆ "	1 ⁹ / ₁₆ "

